

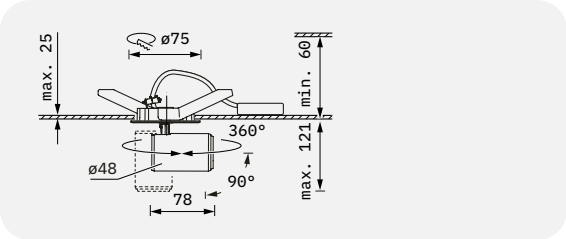

# Coray CXN



- Lighting technology LED
  - Tool-less ceiling mounting
  - Ceiling cut-out Ø75 mm
  - Floor and wall mounting not permitted
  - Turning and tilting (360°/90°)
  - With integral reflector SSP, SP or MFL
  - Supply unit included
  - Connection to power supply by Wieland plug GST18i3; wire length l = 0.5 m
  - Version with DALI or Casambi on request (Casambi not compatible with metal ceilings)
- Colours: white, anthracite, silver on request



- 100% recyclable
  - Designed in accordance with the Ecodesign Directive (2019/2020/EU)
  - Long LED life due to efficient thermal management
- 

## Photometric data

CRI Colour quality	Power level	
	Luminous flux luminaire [lm]	System efficiency [lm/W]
830	600	67
840	600	67
927	500	56
930	500	56

Maximum possible, optionally available connected load: 9 W.  
According to IEC 62722-1 the given rated values of the total luminous flux and of the electric power must not deviate by more than 10%. The photometric values are

standard values and refer to the entire luminaire. Other light qualities on request to info@ansorg.com. This product contains two light sources of energy efficiency class D (830/840) or E (927/930).

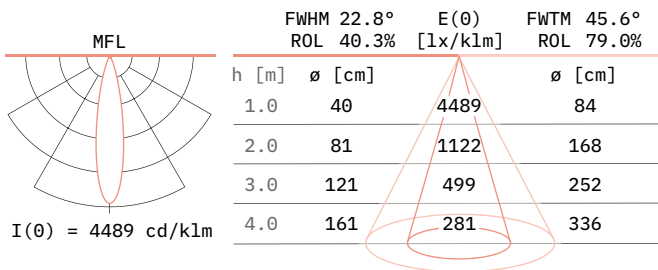
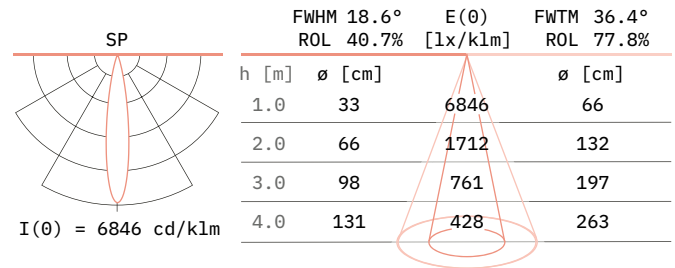
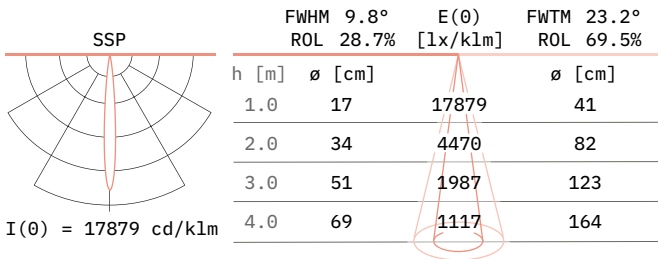

## Technical data

Information	Values
Connection data	220-240 V, 50/60 Hz (110-277 V on request)
Weight	approx. 0,8 kg
Colour tolerance	3SDCM (MacAdam)
Lumen maintenance	L80/B10 ≥ 50,000h, Ta 25 °C L90/B50 ≥ 50,000h, Ta 25 °C
Failure rate	C0/B10 ≥ 50,000h, Ta 25 °C
Photobiological safety	RG1
Number per circuit breaker B 16A	25
Protection class	1
Type of protection	IP20
Certification mark	ENEC

## Optional accessories

Product	Option
Lentille convergente interchangeable	SSP, SP, MFL