

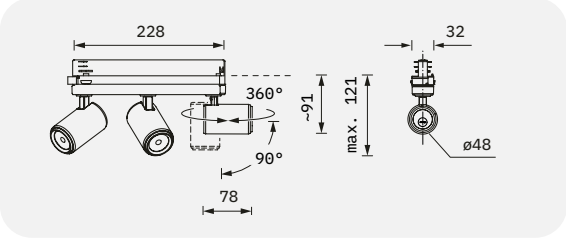

# Coray CXT



- Lighting technology LED
  - Tool-less mounting with track adapter for three-circuit track
  - Floor and wall mounting not permitted
  - Turning and tilting (360°/90°)
  - With integral collimator SSP, SP or MFL
  - Supply unit included
  - Version with DALI on request
- Colours: white, anthracite, silver on request



- 100% recyclable
  - Designed in accordance with the Ecodesign Directive (2019/2020/EU)
  - Long LED life due to efficient thermal management
- 

## Photometric data

CRI Colour quality	Power level	
	Luminous flux luminaire [lm]	System efficiency [lm/W]
830	1800	67
840	1800	67
927	1500	56
930	1500	56

Maximum possible, optionally available connected load: 27 W.  
According to IEC 62722-1 the given rated values of the total luminous flux and of the electric power must not deviate by more than 10%. The photometric values are

standard values and refer to the entire luminaire. Other light qualities on request to info@ansorg.com. This product contains two light sources of energy efficiency class D (830/840) or E (927/930).

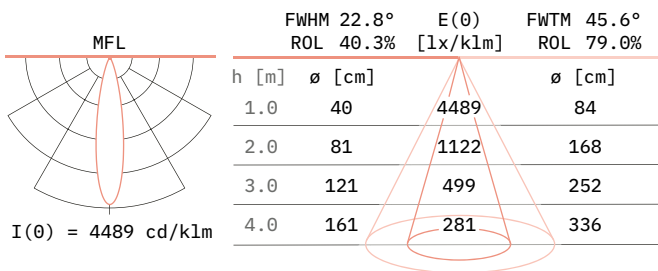
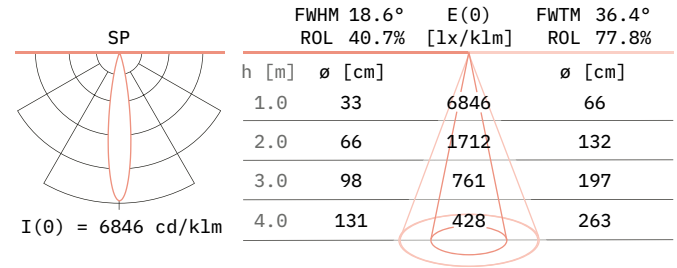
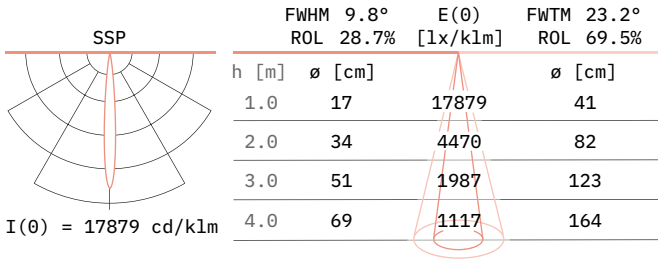

## Technical data

Information	Values
Connection data	220-240 V, 50/60 Hz (110-277 V on request)
Weight	approx. 0.8 kg
Colour tolerance	3SDCM (MacAdam)
Lumen maintenance	L80/B10 ≥ 50,000h, Ta 25 °C L90/B50 ≥ 50,000h, Ta 25 °C
Failure rate	C0/B10 ≥ 50,000h, Ta 25 °C
Photobiological safety	RG2
Number per circuit breaker B 16A	50
Protection class	2
Type of protection	IP20
Certification mark	ENEC / CB

## Optional accessories

Product	Option
Interchangeable collimator	SSP, SP, MFL